

Pulmones freno de servicio

Service brake chambers

Câmaras freio de serviço

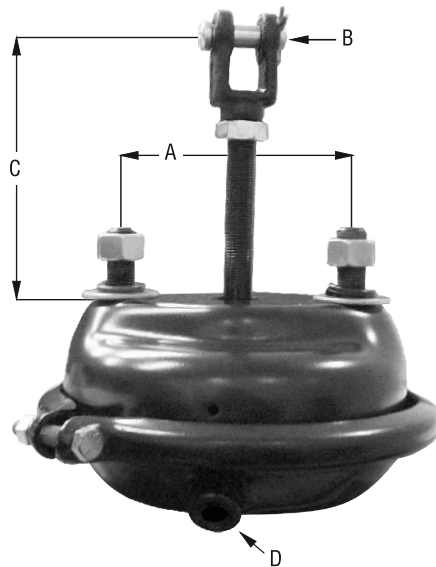

Código / Code	Tipo / Type	Ø	A	B	C	D	Modelos / Models
R-1005	12"	5" 1/2	76,2mm.	Ø 1/2	225mm.	1/4 NPT	Eje direccional remolques / Trailer directional axle Eixo direccional reboques Mack - Delantero / Front / Dianteiro
R-1015	16"	6" 1/2	76,2mm.	Ø 1/2	250mm.	1/4 NPT	Eje direccional remolques / Trailer directional axle Eixo direccional reboques Ford F 14000 - Delantero / Front / Dianteiro
R-1020	20"	6" 3/4	121mm.	Ø 1/2	105mm.	1/4 NPT	Mercedes Benz L/LO 1114 - OC/OF 1214 Sist. Frenarsa Scania L 76 - Iveco Eurocargo - Delantero / Front / Dianteiro
R-1030	24"	7"	121mm.	Ø 1/2	195mm.	3/8 NPT	Remolques / Trailers / Reboques El Detalle OA 101/105 Iveco Eurotrakker / Eurotech Ford F 7000 / Cargo - Dodge DP 800 Chevrolet 714 - Scania L111 Delantero / Front / Dianteiro
R-1032	24"	7"	121mm.	Ø 1/2	270mm.	M-16	Danes (suspensión Boero ITG)
R-1040	30"	8"	121mm.	Ø 1/2	165mm.	3/8 NPT	Remolques / Trailers / Reboques Ford F 900 - Dodge DP 800 - Chevrolet 714 Trasero / Rear / Traseiro
R-1041	30"	8"	121mm.	Ø 1/2	95mm.	3/8 NPT	Remolques / Trailers / Reboques (Brasil)
R-1042	30"	8"	121mm.	Ø 1/2	130mm.	3/8 NPT	Remolques / Trailers / Reboques
R-1043	30"	8"	121mm.	Ø 1/2	280mm.	3/8 NPT	Remolques / Trailers / Reboques (Susp. Boero ITG)
R-1050	30"	8"	76,2mm.	Ø 1/2	190mm.	3/8 NPT	Remolques / Trailers / Reboques Helvética M-70
R-1060	30"	8"	121mm.	Ø 1/2	165mm.	3/8 NPT	Mercedes Benz L/LO 1114 - OC/OF 1214 Sist. Frenarsa - Trasero / Rear / Traseiro
R-1070	36"	9"	121mm.	Ø 1/2	155mm.	3/8 NPT	Remolques / Trailers / Reboques Scania L76 - Volvo NL 10/12 - Trasero / Rear / Traseiro
R-1073	36"	9"	121mm.	Ø 1/2	90mm.	3/8 NPT	Remolques / Trailers / Reboques (Brasil)

Pulmones freno de servicio tipo Wabco

Service brake chambers Wabco type

Câmaras freio de serviço tipo Wabco

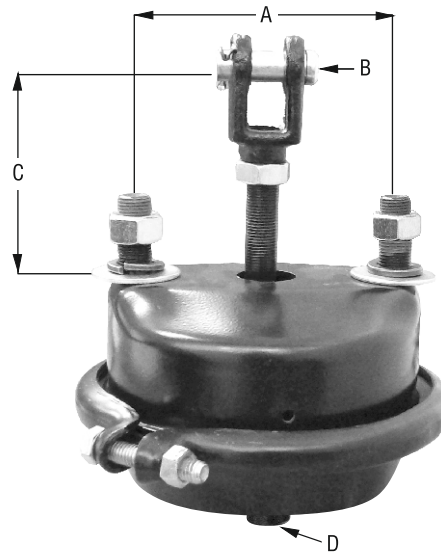

Código/Code	Tipo/Type	Original Nº	A	B	C	D	Modelos / Models
W-1010	12"	423 103 100 0	98,9mm.	Ø 14mm.	85mm.	M-16	M. Benz Argentina: L/LO 1114 - L 1215 M. Benz Brasil: L 1113/1114/1214 - OF 1113 Delantero / Front / Dianteiro
W-1011	14"	423 114 000 0	110mm.	Ø 14mm.	85mm.	M-16	M. Benz Argentina: L/LO 1114 - OH 1315 M. Benz Brasil: L 1313/1314/1316/1318/1418 OF 1313/1316 - OH 1313/1316/1318/1420 Delantero / Front / Dianteiro
W-1012	16"	423 104 606 0	121mm.	Ø 14mm.	85mm.	M-16	M. Benz Argentina: L 1526/1620 - OH 1315 OHL 1420 - OH 1618L M. Benz Brasil: L 1513/1516/1519/1618/2013 2019/2213/2216/2219/2224/2314/2318 OH 1517/1518 - OF 1620 Delantero / Front / Dianteiro
W-1013	20"	423 105 ... 0	121mm.	Ø 14mm.	85mm.	M-16	M. Benz Argentina: L 1935/1941 - OHL 1420 M. Benz Brasil: LA 1418 - LS 1924/1929/1933/1941 O 370/371/400 Scania R/T/K 124/113 - F/S/K 113 - P 94 Delantero / Front / Dianteiro
W-1014	24"	423 106 ... 0 884 502 ... 0	121mm.	Ø 14mm.	75mm.	M-16	M. Benz Argentina: L 1935/1941 OHL 1420 - OH 1621L M. Benz Brasil: LS 1935/1941 - L 2635 Scania R/T 113/124/143 - Volvo NL 10/12 - FH 12 Delantero / Front / Dianteiro
W-1018	24"	423 106 900 0	121mm.	Ø 14mm.	190mm.	M-16 (x 2)	Remolques europeos European trailers Reboques europeus
W-1015	30"	423 107 ... 0	121mm.	Ø 14mm.	75mm.	M-16	Volvo NL 10/12 - B 58 - B 10M - B 12 - B 7 Delantero / Front / Dianteiro
W-1019	30"	423 107 900 0	121mm.	Ø 14mm.	190mm.	M-16 (x 2)	Remolques europeos European trailers Reboques europeus

Pulmones freno de servicio

Service brake chambers

Câmaras freio de serviço



Repuestos / Spare parts / Peças



R-1420 Ø 1/2



R-0760 12"

R-0755 16" - 20"

R-0750 24" - 30"

R-0720 36"



R-1211 (5/16) 12" - 16" - 20"

R-1210 (3/8) 24" - 30" - 36"



R-1405 1/2 NF x Ø 1/2 12" - 16"

R-1410 5/8 NF x Ø 1/2 20" - 24" - 30" - 36"



R-1240 12"

R-1250 16"

R-1260 20"

R-1270 24"

R-1280 30"

R-1295 36"



R-1310 12" (Ø 5"1/2) 234226

R-1320 16" (Ø 6"1/2) 234189

R-1340 20" (Ø 6"3/4) 234099

R-1350 24" (Ø 7") 234100

R-1360 30" (Ø 8") 234101

R-1370 30" (Ø 8") Helvética M70

R-1380 36" (Ø 9") 234362

Pulmones freno de servicio tipo Wabco

Service brake chambers Wabco type

Câmaras freio de serviço tipo Wabco

Repuestos / Spare parts / Peças



W-1440 Ø 14mm.



R-0755 12" - 14" - 16" - 20"

R-0750 24" - 30"



R-1211 (5/16) 14" - 16" - 20" - 12"

R-1210 (3/8) 24" - 30"

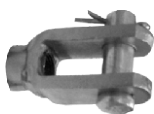

W-1413 M-16 x Ø 14mm.



R-1240 12"

R-1245 14"

R-1250 16"

R-1260 20"

R-1270 24"

R-1280 30"



W-1390 12" 897 120 505 4

W-1391 14" 897 121 615 4

W-1394 16" 897 120 510 4

W-1393 16" L 897 120 516 4

W-1395 20" 897 120 520 4

W-1384 20" L 897 120 526 4

W-1396 24" 897 120 535 4

W-1381 24" L 897 120 536 4

W-1397 30" 897 120 540 4

Pulmones freno de servicio Frenos a Disco

Service brake chambers for Disc Brakes

Câmaras freio de serviço Freios a Disco



	Código / Code	Tipo/Type	Original Nº	Modelos / Models	A	Diafragma / Diaphragm
	W-1027	14"	Knorr BS-3275 II 40358F	Mercedes Benz OH 1115 Delantero Front Dianteiro	M-16	 W-1370 Original Nº 210183-4
	W-1029	16"	Knorr	Remolques con sistema de freno Haldex / Knorr / Wabco	M-16	 W-1394
	R-1033	16"	RG	Remolques con sistema de freno RG	3/8 NPT	 W-1395
	W-1028	20"		M. Benz O 500 OF 1418 / 1722 TATSA Puma Delantero Front Dianteiro	M-16	 R-1350
	W-1026	24"	RG	Renault Premium Delantero Front Dianteiro	M-16	
	R-1035	24"	RG	Embolsadoras Richiger	3/8	

Pulmón freno de servicio Frenos de Cuña

Service brake chamber for Wedge Brakes

Câmara freio de serviço Freios de Cunha



	Código / Code	Tipo/Type	Original Nº	Modelo / Model
	W-1030	12"	Knorr BZ-3217 Wabco 423 143 001 0 Iveco 41211304	Astra Iveco Eurotraker Delantero Front Dianteiro

Pulmones freno de servicio Fiat Iveco

Service brake chambers Fiat Iveco

Câmaras freio de serviço Fiat Iveco



	Código / Code	Original Nº	Ø	Modelos / Models
	E-6250	Marelli AC 334 B Meccast 4016 A	125mm.	Fiat Iveco 673 / 619 / 697 Delantero / Trasero Front / Rear Dianteiro / Traseiro Fiat Iveco 150 / 130AU / 190.33 Delantero Front Dianteiro
	No disponible Not available Nao disponível	Marelli AC 334 W Meccast 4031 A	115mm.	Fiat Iveco 619 / 697 / 150 130 AU / 190.29 Delantero Front Dianteiro

Repuestos / Spare parts / Peças



E-6235 Ø 1/2



E-6240



E-6270 Ø 125mm.



E-6230

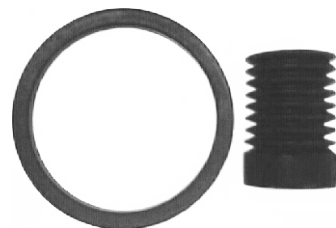

E-6210 Ø 115mm.

E-6260 Ø 125mm.